

Mechanical:

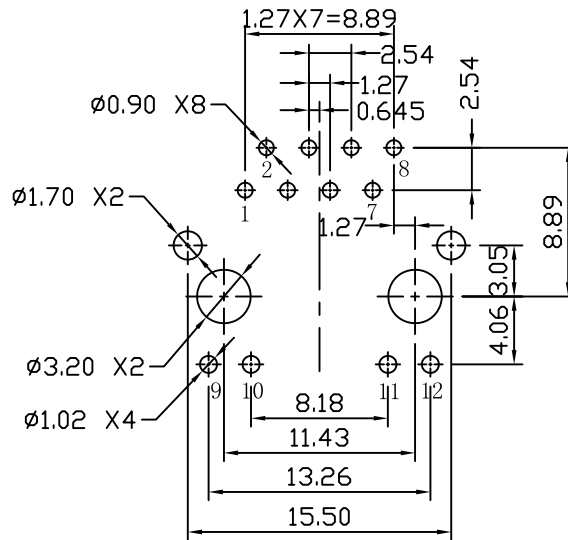
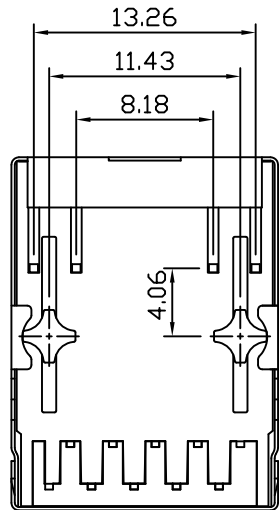
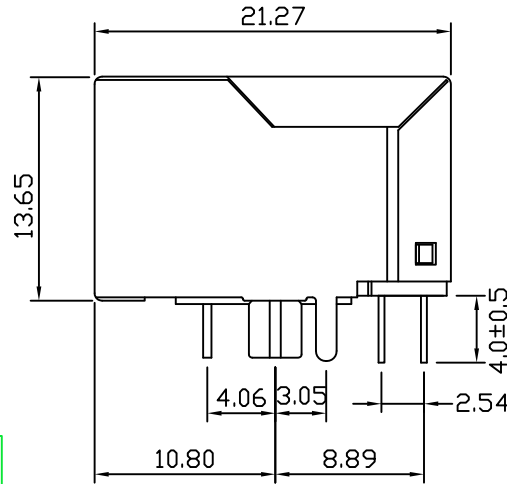
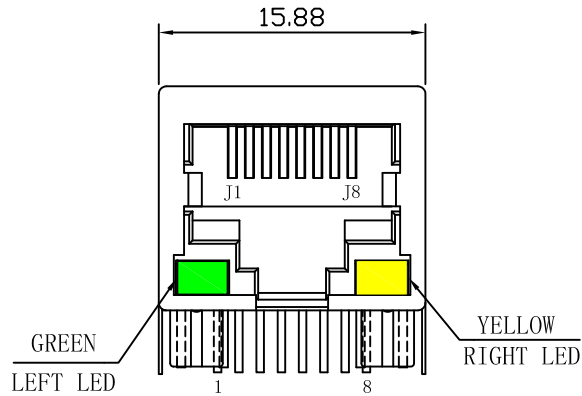

SUGGESTED PCB LAYOUT(TOP VIEW)

REV.	ECN NO.	DESCRIPTION	DATE	APPD
A	REL		24/10/2009	

MATERIAL:

1. Housing material: Glass filled polyester UL94V-0.
2. Contact material: Phosphor bronze $\phi 0.46\text{mm}$.
3. Plating: Gold plating over nickel.
4. Shield: 0.23mm thickness copper alloy with nickel plated.

PCB JACK Electrical:

1. Voltage Rating: 125VAC RMS
2. Current Rating: 1.5AMP
3. Contact Resistance: 30 Miuiohms Max
4. Insulation Resistance: 500 Megohms Min@500VDC.
5. Dielectric Strength: 1000VAC RMS 50Hz 1Min.
6. Operating: 750 Cycles Min.
7. Plating Gold Thickness:
Gold Flash/1.5"/3u"/6u"/15u"/30u"/50u"
8. Wave solder tip temperature: 265°C Max, 5 Sec Max.

Environmental:

1. Storage: $-40^{\circ}\text{C} \sim +85^{\circ}\text{C}$.
2. Operation: $-40^{\circ}\text{C} \sim +85^{\circ}\text{C}$.

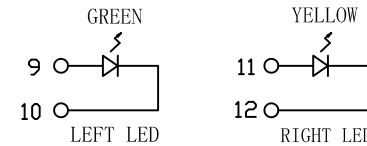

Emitting Color	$\lambda_p(\text{nm})$	VF@IF=20mA	IR @VR=5V
GREEN	565	1.8-2.6V	10 μA max
YELLOW	585	1.8-2.6V	10 μA max

X:X	± 0.30	APPD:	LINK-PP INT'L TECHNOLOGY CO., LIMITED	
X:XX	± 0.25	CHKD:	TITLE: RJ45 1×1 CONNECTOR, Cat5E	
X:XXX	± 0.05	DR: TOM	PART NO.: LPJE160HENL	
ANGLES	$\pm 1^{\circ}$	UNIT: mm		
	SCALE: 2/1	SHEET: 1/1	REV: A	DWG NO.: LP09102423