

Schematic :

REV.	ECN NO.	DESCRIPTION	DATE	APPD
A	REL		2011/06/02	

PC BOARD CONNECTIONS

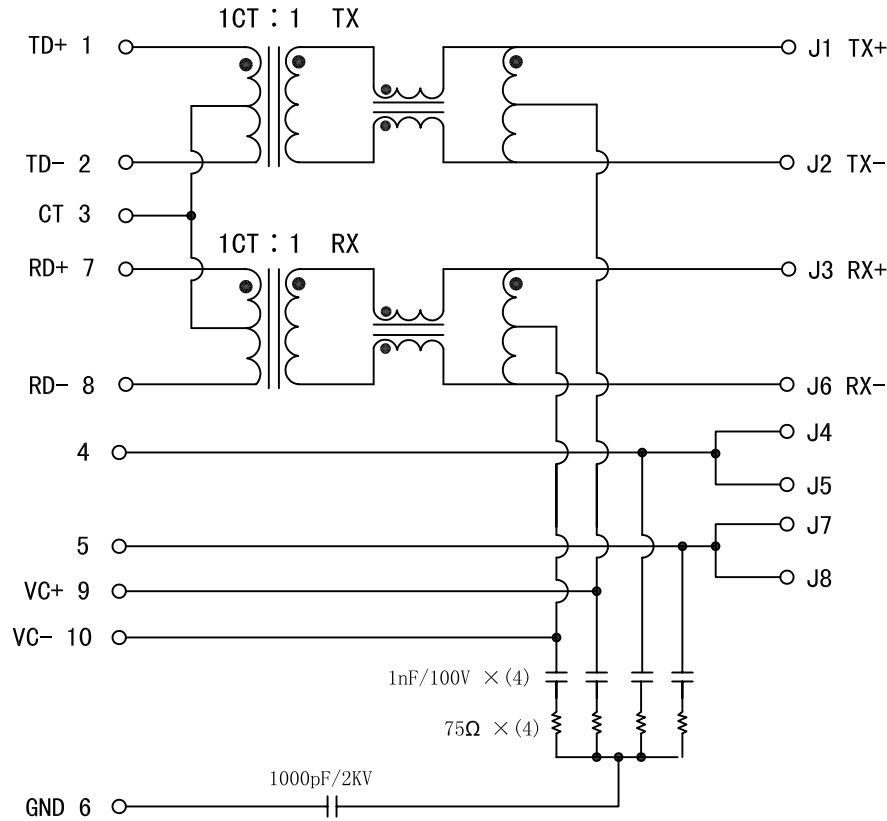

RJ45 CONNECTOR

Electrical Specifications @25°C

- Turns Ratio ($\pm 2\%$) :
TX=1CT:1 RX=1CT:1
- Inductance OCL: 350uH min
@100KHz, 0.1Vrms, 8mADC Bias
- Insertion Loss:
0.3-100MHz:-1.5dB Max
- Return Loss(dB Min) :
2-30MHz:-16;
60-80MHz:-10
- Crosstalk(dB Min) :
0.3-100MHz:-30
- Isolation Voltage:
1000Vrms/0.5mA/2Sec
- Balanced DC Line Current:
350mA Max. @57VDC for 200 Millseconds
- Operating Temperature: 0°C ~ 70°C.

GREEN/LEFT LED

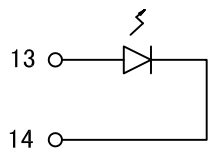

YELLOW/RIGHT LED

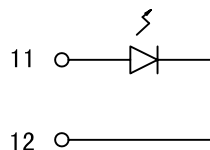

X:X	± 0.20	APPD:	LINK-PP INT'L TECHNOLOGY CO., LIMITED
X:XX	± 0.10	CHKD:	
X:XXX	± 0.05	DR: TOM	
ANGLES	$\pm 1^\circ$	UNIT: mm	Part No.: LPJ16220BENL
	SCALE: 2/1	SHEET: 1/2	REV: A DWG NO: LP11060202

Mechanical :

REV.	ECN NO.	DESCRIPTION	DATE	APPD
A	REL		2011/06/02	

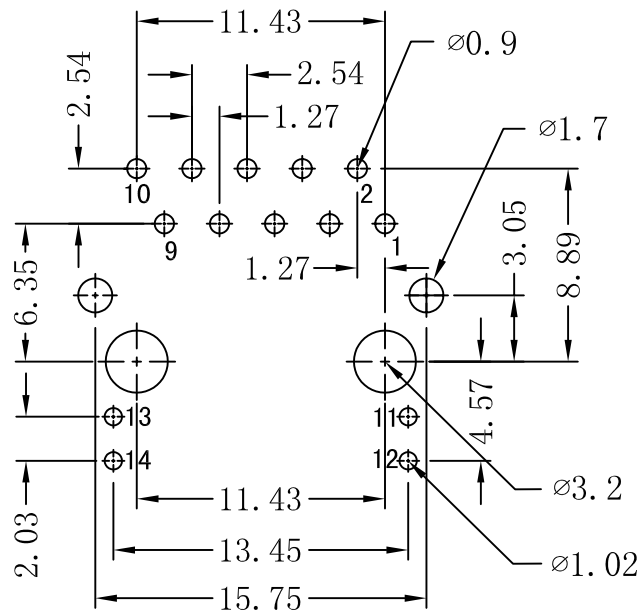
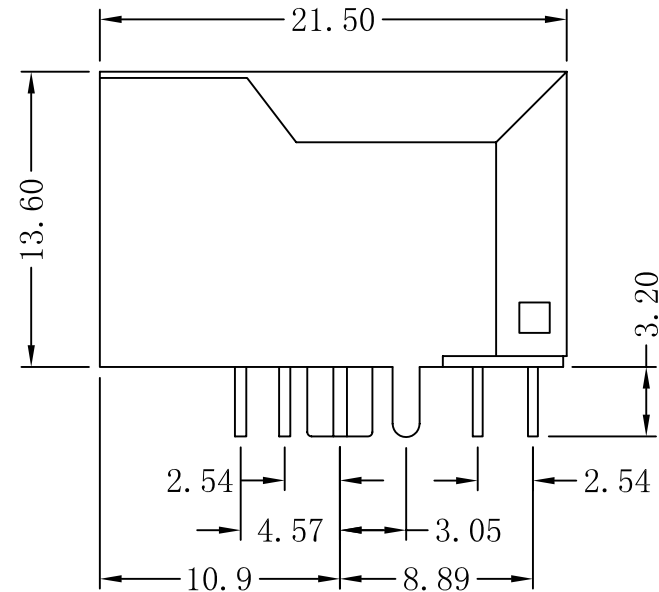
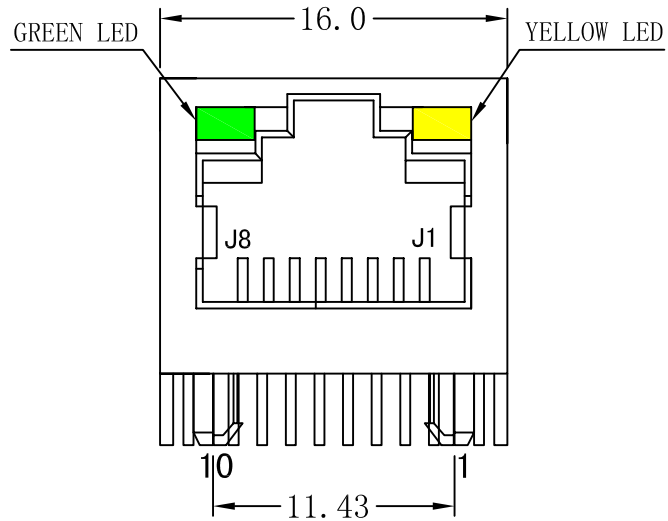

Suggested PCB Layout (TOP VIEW)



NOTES:

1. Designed to support application, such as SOHO (ADSL modems), LAN-on-Motherboard (LOM), hub and Switches.
2. Meets IEEE 802.3 specification
3. Connector Materials:
Housing: Thermoplastic UL94V-0
Contact/Shield: Copper alloy
Shield plating: Nickel
Contact plating: Gold 6 micro-inches min. In contact area.
4. Wave solder tip temperature: 265°C Max
Wave solder tip temperature time: 5 Sec Max

X:X	±0.20	APPD:	LINK-PP INT'L TECHNOLOGY CO., LIMITED
X:XX	±0.10	CHKD:	
X:XXX	±0.05	DR: TOM	Title: RJ45 Connector With 10 /100 Base-TX Integrated Magnetic TAB-UP & PoE
ANGLES	±1°	UNIT: mm	PART NO. : LPJ16220BENL
	SCALE: 2/1	SHEET: 2/2	REV: A DWG NO: LP11060202