

# Mechanical :

REV.	ECN NO.	DESCRIPTION	DATE	APPD
A	REL		2012/07/27	

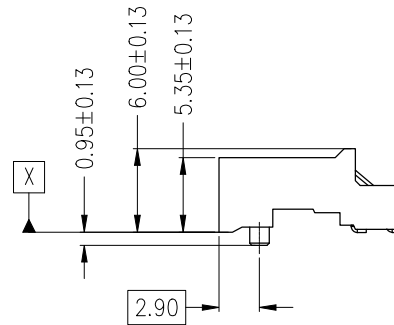
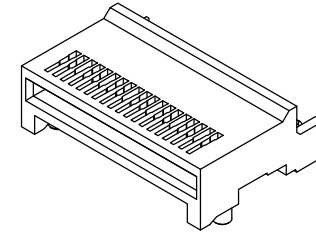
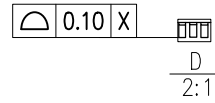
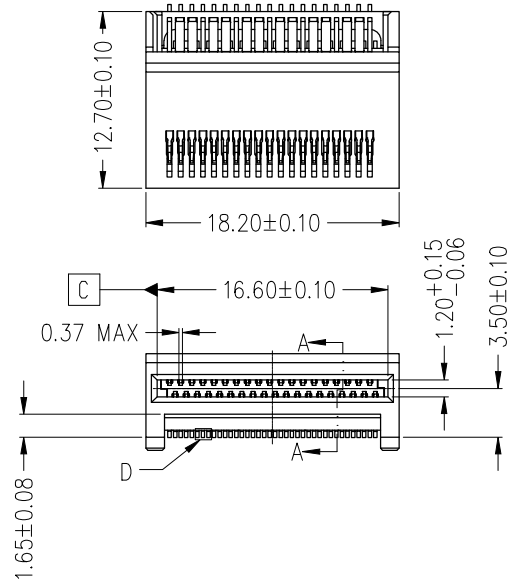

### NOTE:

- Material:  
HOUSING: HIGH TEMPERATURE LCP, BLACK, UL 94 V-0 FLAME RETARDANT.  
2. TERMINAL : NICKEL COPPER ALLOY  
PLATING SPEC AS BELOW:  
OPTION 1  
CONTACT AREA PLATE NICKEL 1.25um MIN, PLATE Gold 0.38um MIN  
SOLDER AREA PLATE NICKEL 1.25um MIN, PLATE MATT TIN 1.5~4.5um  
OPTION 2  
CONTACT AREA PLATE NICKEL 1.25um MIN, PLATE Gold 0.76um MIN  
SOLDER AREA PLATE NICKEL 1.25um MIN, PLATE MATT TIN 1.5~4.5um
- ELECTRICAL CHARACTERISTICS  
CONTACT CURRENT RATING: 0.5 AMPERE  
VOLTAGE RATING: 30VAC  
CONTACT RESISTANCE: 50 MILLOHMS MAX  
DIELECTRIC WITHSTANDING VOLTAGE: 300VDC
- ENVIRONMENT  
OPERATION TEMPERATURE: -40° C TO 85° C

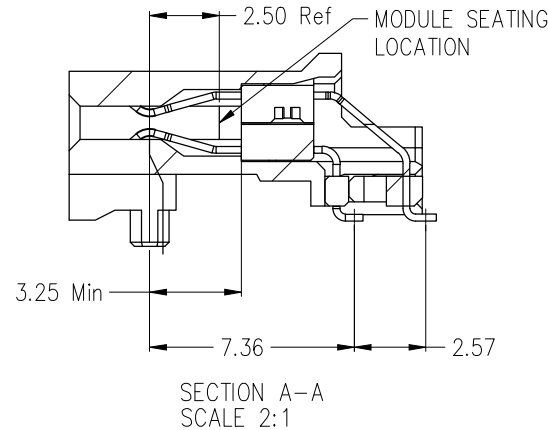
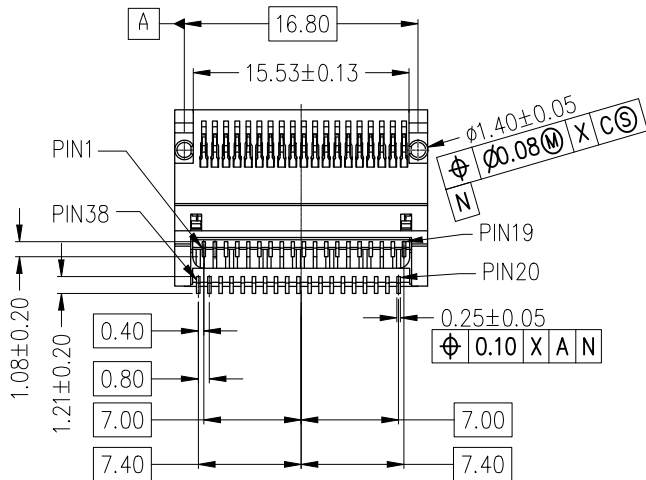

X:X	APPD:	LINK-PP INT'L TECHNOLOGY CO., LIMITED	
X:XX ±0.25	CHKD:	TITLE: QSFP28 1*1 CONNECTOR 38Pos	
X:XXX ±0.15	DR: James	PART NO. : LP11F004	
ANGLES ±1°	UNIT: mm	REV: A DWG NO. : LP12072705	
	SCALE: 2/1	SHEET: 1/3	

# Mechanical:

REV.	ECN NO.	DESCRIPTION	DATE	APPD
A	REL		2012/07/27	

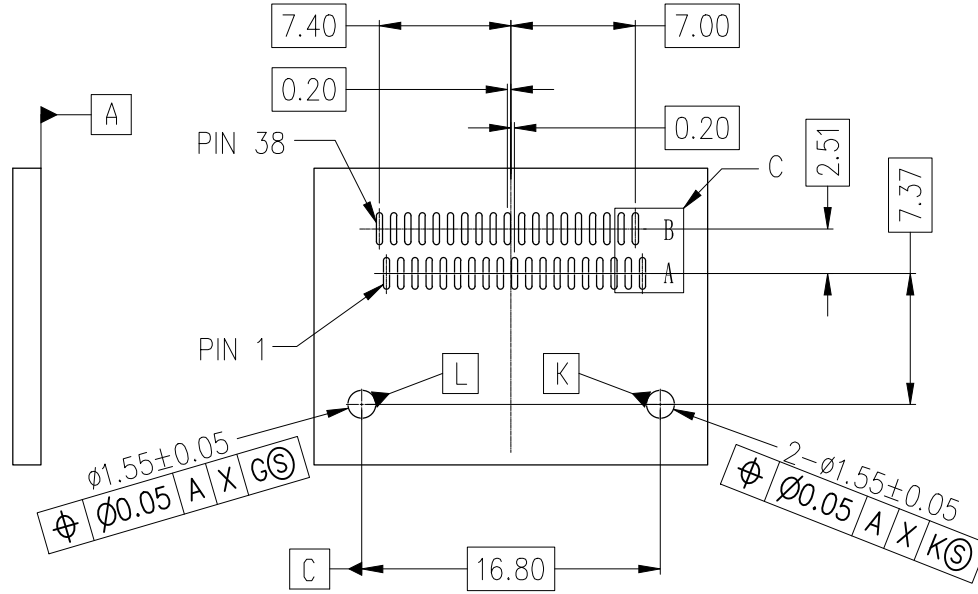

RECOMMENDED PCB DIMENSION TOLERANCE  $\pm 0.05$

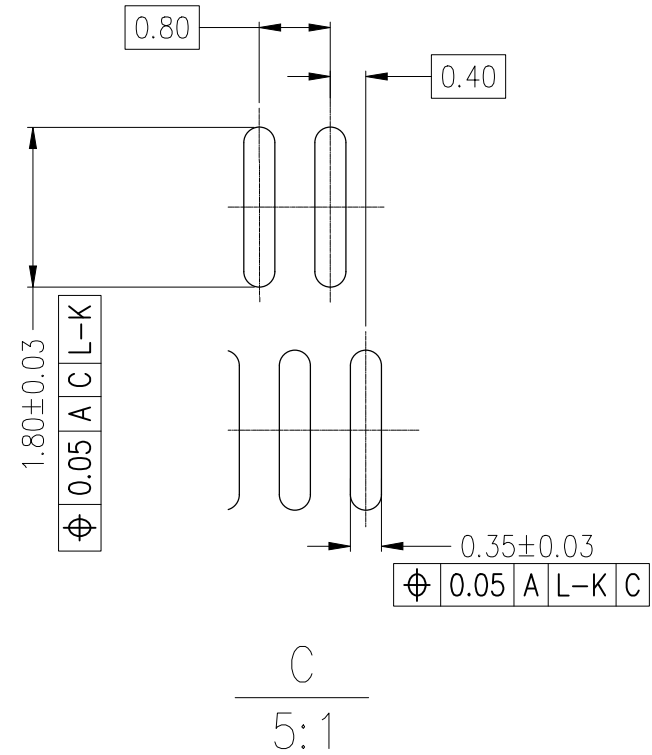

X:X	APPD:	LINK-PP INT'L TECHNOLOGY CO., LIMITED	
X:XX $\pm 0.25$	CHKD:	TITLE: QSFP28 1*1 CONNECTOR 38Pos	
X:XXX $\pm 0.15$	DR: James	PART NO.: LP11F004	
ANGLES $\pm 1^\circ$	UNIT: mm	DWG NO.: LP12072705	
	SCALE: 2/1	SHEET: 2/3	REV: A

# Mechanical:

REV.	ECN NO.	DESCRIPTION	DATE	APPD
A	REL		2012/07/27	

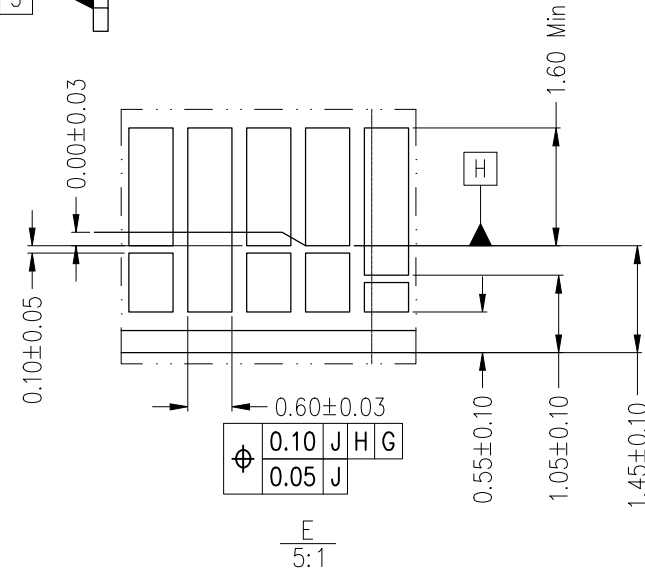
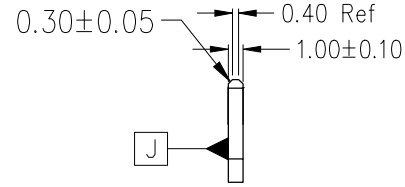
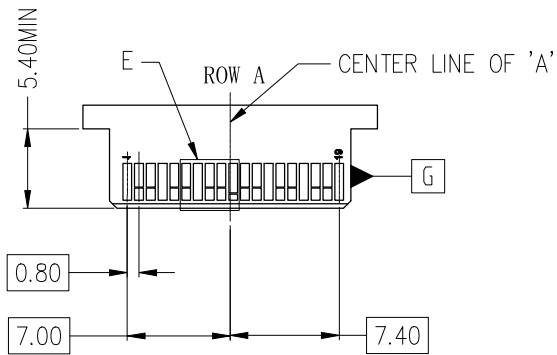
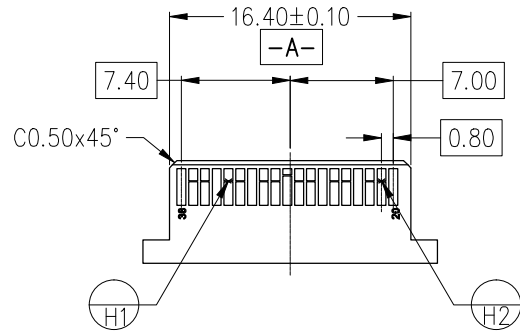

## NOTES:

- 1 DATUM G- DEFINED BY CENTERLINE OF PADDLE CARD WIDTH
- 2 DATUM H- DEFINED BY LEADING EDGE OUTER MOST OF THIRD MATE CONTACTS (PADS)  
-TO BE RE-ESTABLISHED ON EACH SIDE
3. DATUM J- DEFINED BY TOP SURFACE OF PADDLE CARD  
NO SOLDER MASK WITHIN 0.05 OF ALL DEFINED CONTACT PAD EDGES  
NO SOLDER MASK BETWEEN END END CONTACTS AND THE SIDE EDGES OF THE PADDLE CARD

X:X	APPD:	LINK-PP INT'L TECHNOLOGY CO., LIMITED
X:XX ±0.25	CHKD:	
X:XXX ±0.15	DR: James	TITLE: QSFP28 1*1 CONNECTOR 38Pos
ANGLES ±1°	UNIT: mm	PART NO.: LP11F004
	SCALE: 2/1	SHEET: 3/3
	REV: A	DWG NO.: LP12072705