

REV	DESCRIPTION OF CHANGE	REVIEWED BY	ISSUE DATE
A	FIRST ISSUE	LEO	2021-09-02

NOTES:
 1.MATERIAL:
 CAGE: COPPER ALLOY, Ni PLATED
 THICKNESS 0.25mm
 2.PACKAGING: TRAY PACKAGING
 3.TEMPERATURE RANGE: -55°C TO +85°C

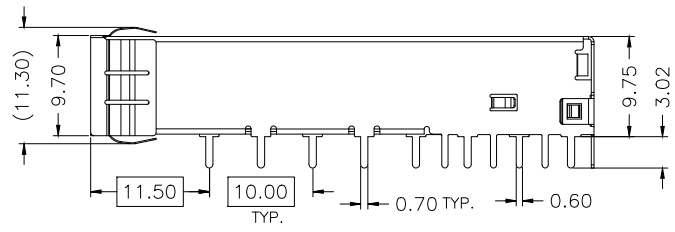

TITLE			LINK-PP INT'L TECHNOLOGY CO., LIMITED		
SFP+ 1x1 CAGE WITH EMI SPRING FINGER					
PART NO.			GENNERAL TOLERANCE		UNIT:MM
LP11BCS1000			• X±0.20	• X±1°	SIZE:A4
APPROVE	CHECK	DRAW	• XX±0.15	• XX±5°	SCALE:1:1
LEO	JAMES	JAMES	• XXX±0.10		SHEET:1/3
					REV:A

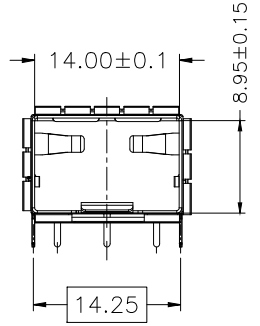
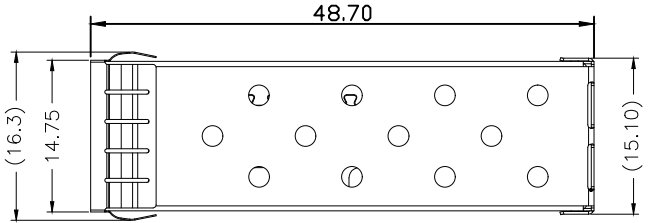
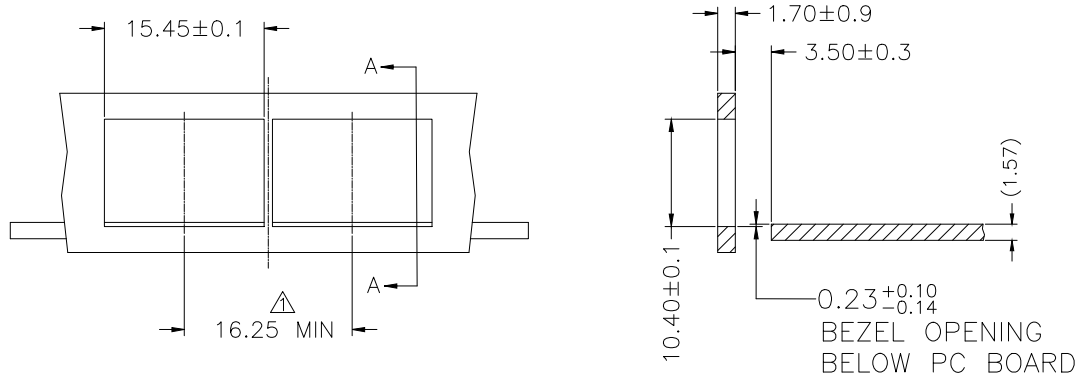

SECTION A-A

RECOMMENDED BEZEL DESIGN

- NOTES:
- ① MINIMUM PITCH ILLUSTRATED, ENGLISH DIMENSIONS ARE FOR REFERENCE ONLY



TITLE SFP+ 1x1 CAGE WITH EMI SPRING FINGER			LINK-PP INT'L TECHNOLOGY CO., LIMITED				
PART NO. LP11BCS1000			GENERAL TOLERANCE			UNIT:MM	SIZE:A4
APPROVE	CHECK	DRAW	• X±0.20	• X±1°	SCALE:1:1	SHEET:3/3	REV:A
LEO	JAMES	JAMES	• XX±0.15	• XX±5°			
			• XXX±0.10				